

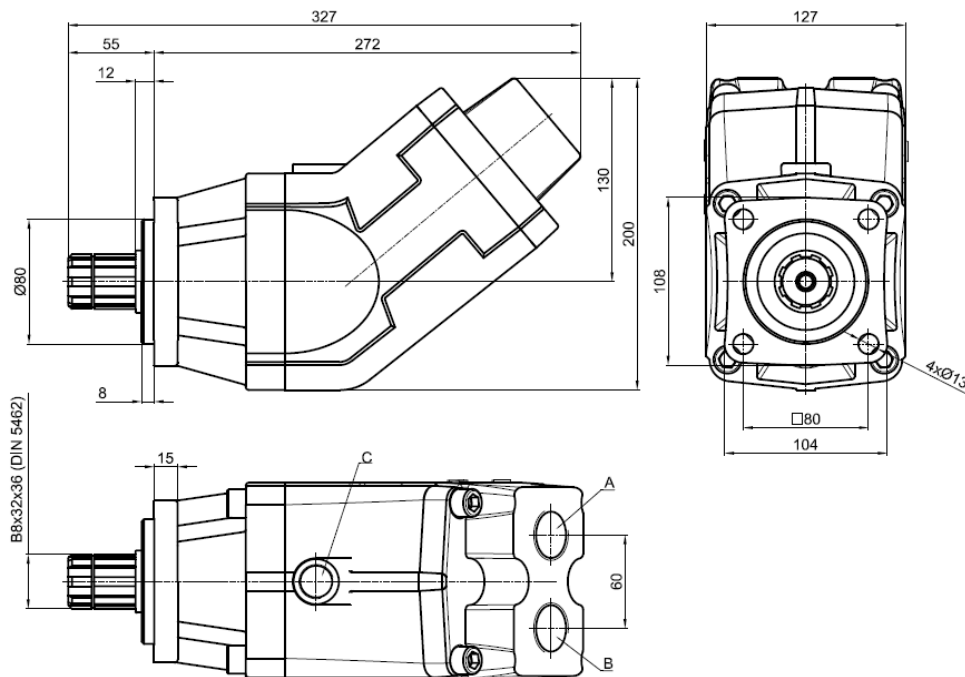

OIL-HYDRAULIC BENT MOTOR AXIAL PISTONS

Ref.
MBI P7

Main Dimensions



(Dimensions in mm)

Main Data

Motors MBI		80P7	110P7	125P7	135P7
Cylinder capacity (cm³/rot.)		80	108	126	136
Rotation (rpm)	max. intermittent	3000	2800	2500	2500
	max. continuous	2400	2250	2000	2000
Pressure (bar)	max. intermittent	400	400	350	300
	max. continuous	350	350	300	250
Max torque – theoretical value (Nm)		505	685	702	645
Weight (kg)		13	13.4	13.5	13.8
Pistons quantity		7	7	7	7
A-Oil port (mm)		1”BSP	1”BSP	1”BSP	1”BSP
B-Oil port (mm)		1”BSP	1”BSP	1”BSP	1”BSP
C-Drain hole		M22x1.5	M22x1.5	M22x1.5	M22x1.5

How to order:

Example: Motor 80cm³/rot.; pressures 400/350 bar; rotation 3000/2400; ref. MBI P7 → MBI80P7

Important notes:

-To install one of these motors, please consult and respect the instruction “BI motors recommendations before start-up”.

ABER is constantly engaged in improving its products and, therefore, reserves itself the right to modify without any further notice the characteristics shown



ABER - Embraiaçes e Comandos Hidráulicos - A. B. LDA

Rua Francisco de Almeida, Nº 30 – Vila Nova da Telha – 4470 MAIA - Portugal

Telephone: +351.22.9438070 Fax: +351.22.9420823 e-mail: aber@aber.pt <http://www.aber.pt>